

Series 2000 Workcentre - WCA200

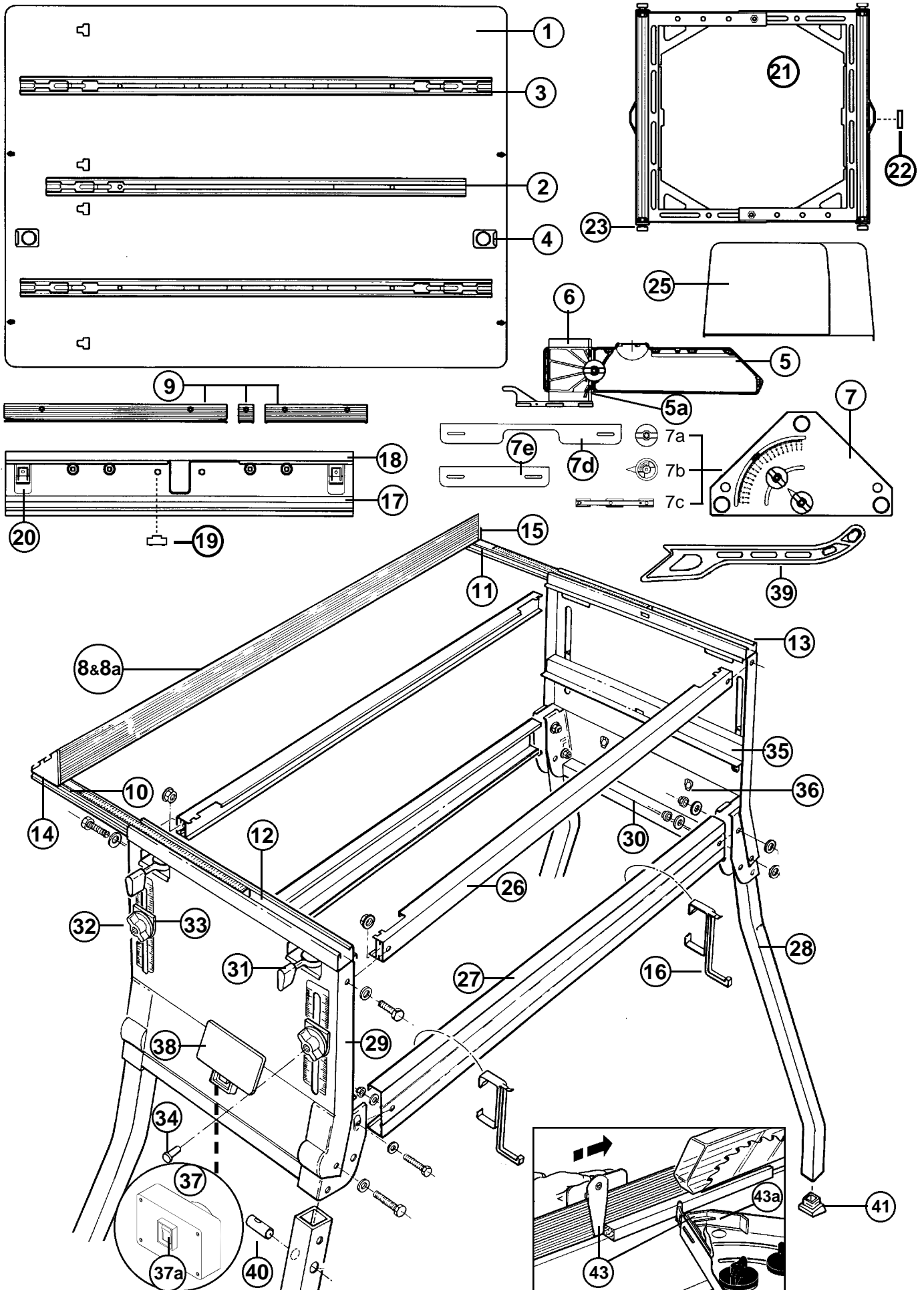

Series 2000 Workcentre - WCA200

Introduced October 1996

Diag. Ref.	Part No.	Description	Qty Supplied as Spare Part	Comments
-	PUA276	Packing Carton No. 1	1	
-	PUA281	Packing Carton No. 2	1	
-	PUA285	Assembly & Operating Manual	1	
1	WCA 235	Table Top (complete)	1	Includes infill strips
2	WCA330	Saw Slot Repair Kit (centre infill strip)	1	
3	WCA318	Table Infill Strip (outer)	1	
4	WCA332	Table Latch (complete)	1	
5	WCA333	Overhead Guard	1	Includes 6mm bolt & knob
5a	WCA192	Overhead Guard Hold-down Fingers	2	
6	WCA334	Guard Support	1	
7	WCA251	Protractor (complete)	1	
7a	WCA335	Protractor Knob	1	Includes M6 nut
7b	WCA223	Protractor Lock Pointer	1	
7c	WCA222	Protractor Slide Strip	1	
7d	WCA220	Protractor Sandpaper (long)	1	
7e	WCA221	Protractor Sandpaper (short)	1	
8	WCA336	Rip Fence (no bevel guides)	1	Includes inner tracks (10 & 11)
8a	WCA210	Rip Fence (no fittings)	1	Extrusion only
9	WCA337	Rip Fence Bevel Guide Set	1	Set of 3
10	WCA259	Fence Track Inner - Front	1	
11	WCA260	Fence Track Inner - Rear	1	
12	WCA313	Fence Track Outer - Front	1	
13	WCA283	Fence Track Outer - Rear	1	
14	WCA217	Fence Cap - front	1	
15	WCA218	Fence Cap - rear	1	
16	WCA293	Fence Hanger	1	
17	WCA338	Cross-Cut Fence (complete)	1	Also suits MK2 & MK3 Workcentres
18	WCA299	MDF Sub-fence (50 x 16mm)	1	
19	WCA339	Nylon Feet for crosscut fence	4	Includes nuts & bolts
20	WCA378	Fence Catches	2	
21	WCA340	Saw Slide Chassis	1	
22	WCA266	Saw Slide Chassis Nylon Catch	1	
23	WCA101	Bearings	4	Includes bolts & nyloc nuts
24	WCA152	Saw Clamp Set (see next page)	4	Includes bolts, nuts & washers
25	WCA160	Saw Side Guard (2 piece)	1	Includes bolts & nyloc nuts
26	WCA247	Bearing Channel	1	
27	WCA256	Base Channel	1	
28	WCA204	Leg	1	
29	WCA274	End Panel Assembly - front	1	
30	WCA279	End Panel Assembly - rear	1	
31	WCA342	Cam Lock Assembly	1	
32	WCA343	Table Support Bag / Kit	1	Includes knob, bolt & indicator
33	WCA285	Nylon Scale Indicator	4	
34	WCA281	Push Stick Hanger	2	
35	WCA254	Table Support Rail	1	Front & rear identical
36	WCA267	Protractor Hooks	2	
37	WCA180	Switchbox (complete)	1	
37a	WCA056	Switch 250v 16Amp	1	
38	WCA058	Stop Plate	1	
39	CMA036	Push Stick (discontinued 11/97) - replaced with	Captive Pushtick (part no. WCA369)	
40	WCA245	Leg Lock Pin (complete)	4	
41	CMA042	Angled foot	4	
43	WCA369	Captive Pushstick & Side Pressure Finger Kit	1	
43a	WCA374	Side Pressure Finger Kit (for protractor)	1	2 replacement fingers & holder

Specifications:

Carton 1 - Packed weight: 26.64kg

Pack Size: 893 x 650 x 110mm **Volume:** 0.0638m³

Carton 2 - Packed weight: 8.64kg

Pack Size: 210 x 80 x 990mm **Volume:** 0.0166m³

Paint: Epoxy powder coat (oven cured)

Main Body: Telecom Gold

Legs: Charcoal Grey

Table Infills: Aluminium Powder Coated Silver **Legs:** 30mm Square Tube **Overhead Guard:** Clear Polycarbonate

Bearing Channels & Rip Fence: Aluminium

Bearings: Nylon 66

Sheet Metal Parts: 1.60mm Mild Steel

Series 2000 Workcentre - WCA200

Diag. Ref.	Part No.	Description	Qty as packed in Fastener Bags	Comments
FASTENERS <u>NOT</u> SUPPLIED SEPARATELY - EXCEPT THOSE NOTED BELOW				
42	WCA282	Main Fastener Bag	1	Includes saw clamp set
42a	-	M8 x 16 Bolt	4	} Available in WCA282
42b	-	M8 Flange Nut	4	
42c	-	8mm Washer	20	
42d	-	M8 Nyloc Nut	8	
42e	-	M8 x 50 Bolt	8	
42f	WCA281	Push stick hanger	2	Available separately
42g	-	$\frac{3}{16}$ " Nut	3	Available in WCA282
42h	-	$\frac{3}{16}$ " Screw	3	Available in WCA282
42i	WCA314	Scale Pointer Labels	1pr	} Available separately
42j	CMA042	Angled foot	4	
42k	CMA020	Tube Spanner	1	
42l	AGA001	Trigger Strap	1	
42m	WCA311	Router Table Fitting Kit	1	} Available in WCA152
24a	-	Saw Locator	3	
24b	-	Bevelled Saw Locator	1	
24c	-	$\frac{1}{4}$ " x $1\frac{1}{4}$ " Coach Bolt	1	
24d	-	$\frac{1}{4}$ " x $\frac{5}{8}$ " Flat Washer	8	
24e	-	$\frac{1}{4}$ " Hex Nut	4	
24f	-	Saw Clamp	4	
24g	-	$\frac{1}{4}$ " Spring Washer	4	
24h	-	$\frac{1}{4}$ " Wing Nut	4	
24i	-	Special Saw Clamp	1	
24j	-	$\frac{1}{4}$ " x $\frac{1}{2}$ " Coach Bolt	4	

